

**Volkswagen > B4 Platform > 1995 - 1997**

**Suspension, Wheels, Brakes, Steering**

**40 - Front suspension - Plus suspension, servicing**

**Wheel bearing, suspension strut - Plus suspension, removing and installing**

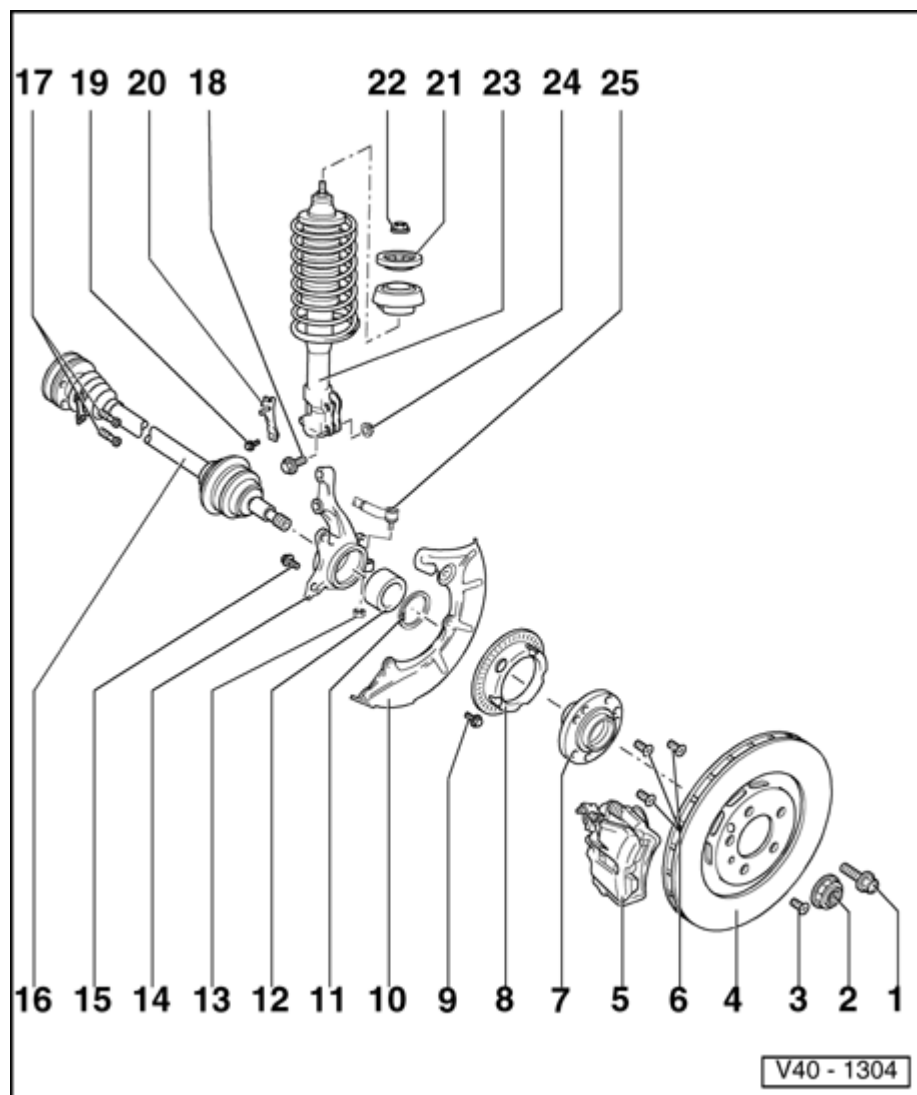

**1 - Wheel bolt, 110 Nm**

**2 - Self-locking 12-point nut**

- ◆ 90 Nm + 45 ° (  $\frac{1}{8}$  ) additional turn.

- ◆ loosening and tightening

- ◆ Remove any paint residue and/or corrosion in the threads of outer joint before screwing on nut.

### **3 - Phillips-head screw**

### **4 - Brake disc**

- ◆ Notes for repairing ⇒ [Front brakes - brake caliper Girling, servicing](#)

### **5 - Brake caliper**

- ◆ Do not remove brake hose when working on front wheel suspension

- ◆ Hang with wire or similar means

- ◆ Replace brake pads ⇒ [Brake pads, removing and installing](#)

### **6 - Metal countersunk screw**

### **7 - Wheel hub**

- ◆ Pressing out

- ◆ Pressing in

- ◆ Remove bearing inner race

### **8 - Rotor for speed sensor**

- ◆ Only on vehicles with ABS

**9 - Hex bolt, 10 Nm**

**10 - Cover plate**

**11 - Securing ring**

- \* Check for proper seating

**12 - Wheel bearing**

- \* Pressing out
- \* Replace, destroyed during ejection
- \* Pressing in

**13 - Self-locking hex nut, 35 Nm**

**14 - Wheel bearing housing**

**15 - Ribbed bolt, 125 Nm**

**16 - Drive axle**

- \* Removing and installing ⇒ [Drive axle with triple rotor joint, removing and installing](#)
- \* Servicing ⇒ [Drive axle, servicing](#)

**17 - Multipoint socket head bolt, 45 Nm**

**18 - Hex bolt**

- \* Camber setting ⇒ [Camber of front wheels, adjusting](#)

- ♦ Mark installation position before loosening

**19 - Hex bolt**

**20 - Bracket**

**21 - Stop**

**22 - Self-locking hex nut, 60 Nm**

- ♦ unbolt and bolt in

**23 - Suspension strut**

- ♦ Disassembling and assembling ⇒ [Front suspension strut - Basic/Plus suspensions, servicing](#)

**24 - Self-locking hex nut, 95 Nm**

**25 - Tie rod**

- ♦ Removing and installing ⇒ [Tie rod - power steering gear, TRW and ZF, removing and installing](#)

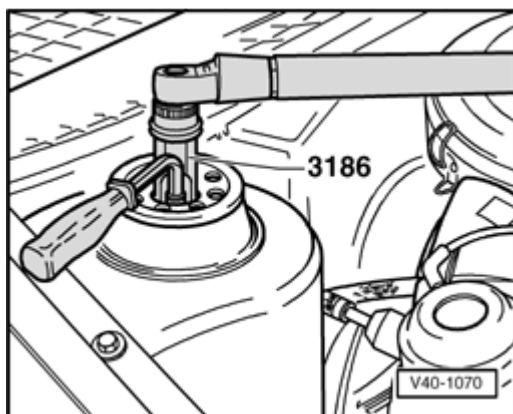

### Removing and installing suspension strut to body

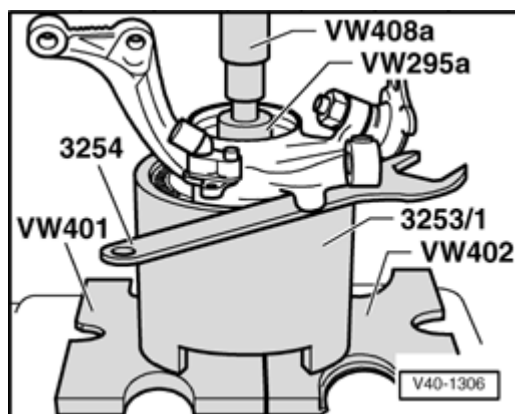

Pressing wheel hub out of wheel bearing housing.

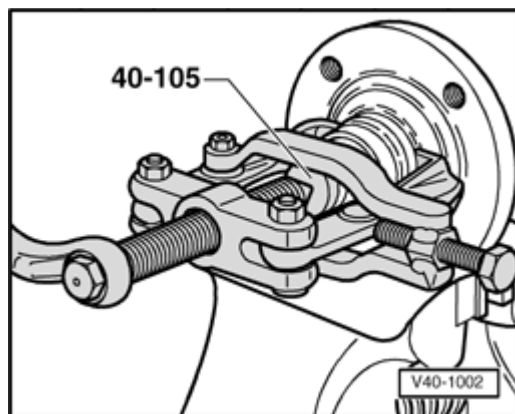

**Pulling bearing inner race off of wheel hub**

Only use puller with tension bracket, e.g. Kukko Puller 204/2 (commercially available).

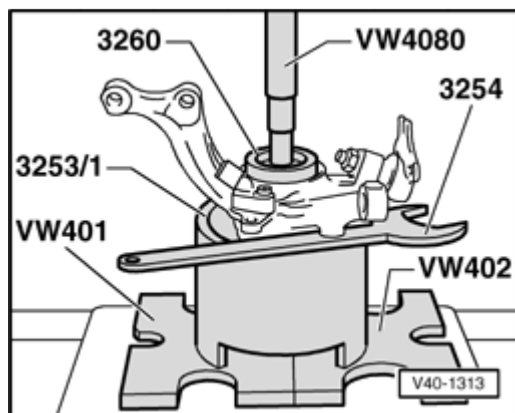

**Pressing wheel bearing out of wheel bearing housing**

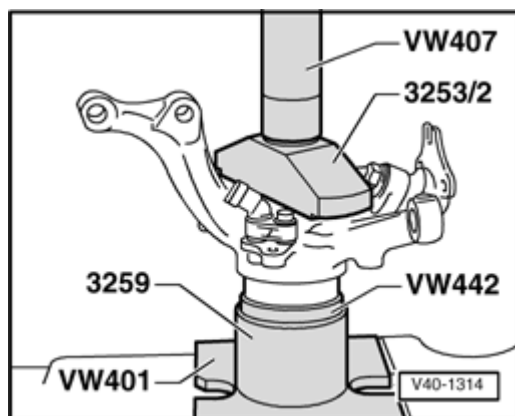

**Pressing wheel bearing in wheel bearing housing**

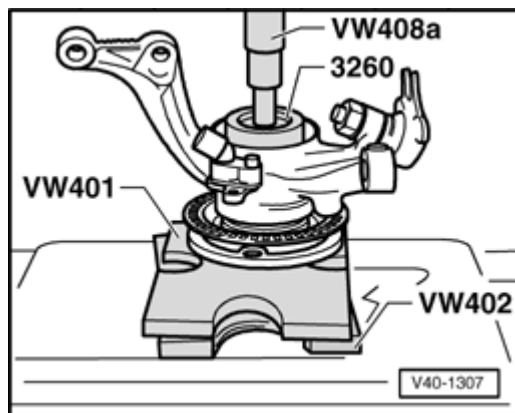

**Pressing wheel hub into wheel bearing housing**